

IndowPRO Installation Quick Start

10 steps to window transformation

- 1) Unpackage and lay out frame components on floor, label side up



- 2) Slide internal corners into frame pieces and slide PRO frame pieces together

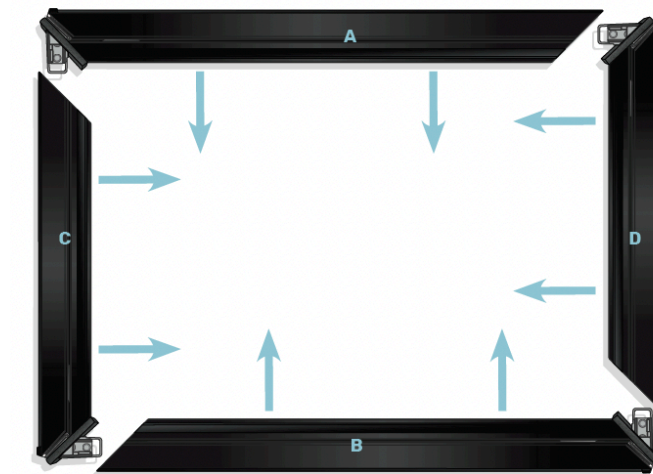

- 3) Attach rear corners

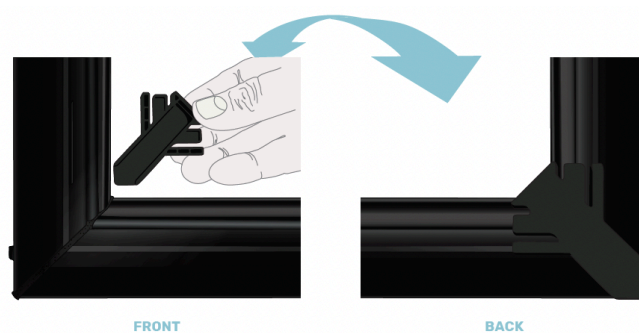

4) Lift PRO frame into primary frame, align

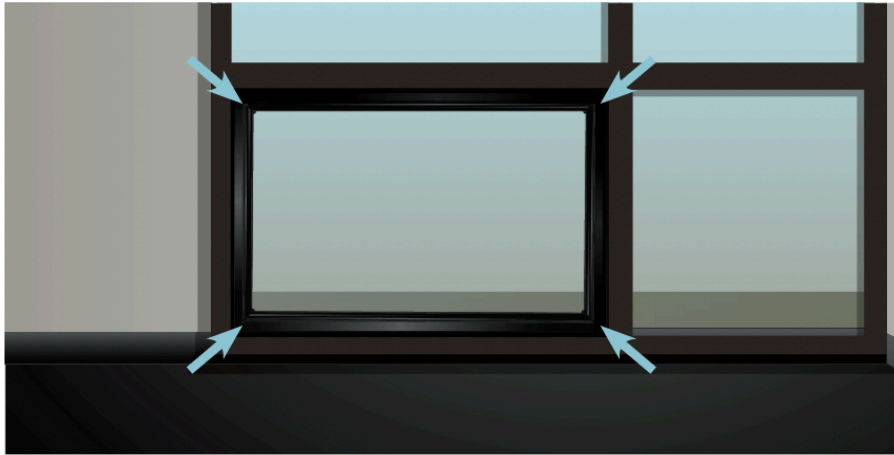

5) Attach PRO frame to primary frame either with screws or VHB tape.

a) Screwless

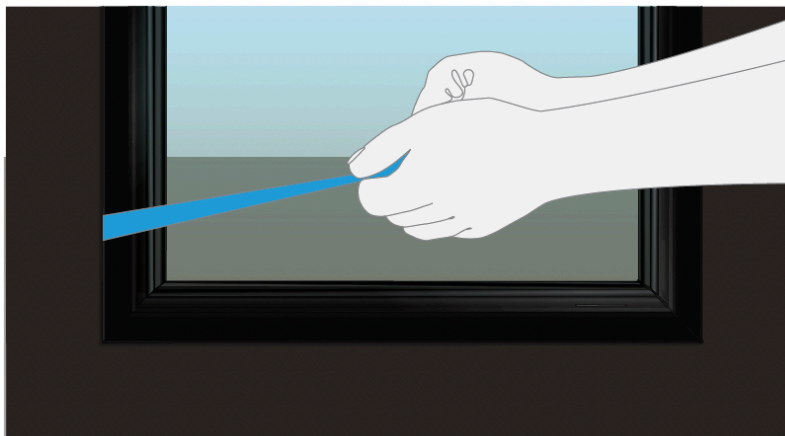

b) Screwed

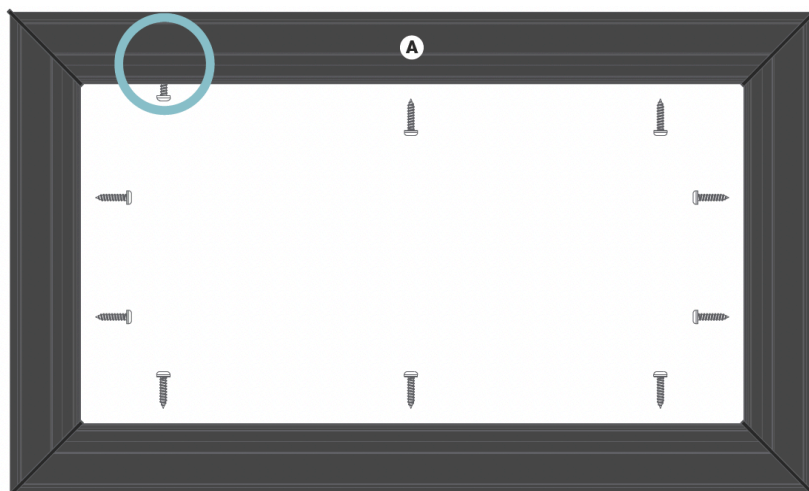

6) Remove desiccant chamber sealing tape

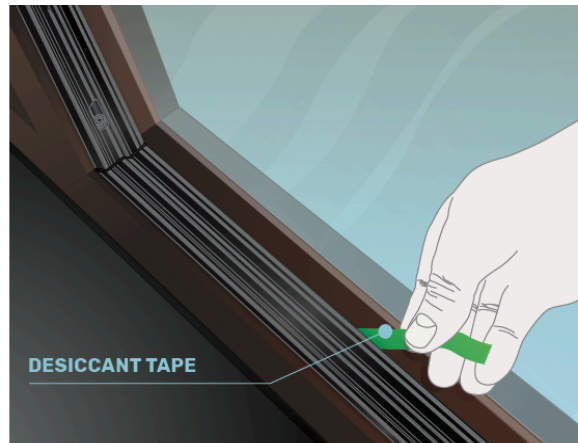

7) Install Glazing



8) Slide in bottom and top Cosmetic Cladding pieces

9) Slide in left and right Cosmetic Cladding pieces

10) Drill 4 holes - drive fasteners

